



Ruta 5 Km 24 - Alta Gracia



03547 - 430962 / 03547 - 15501860



E-mail: miguelangelpremoldeados@gmail.com

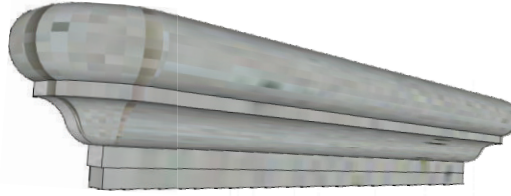
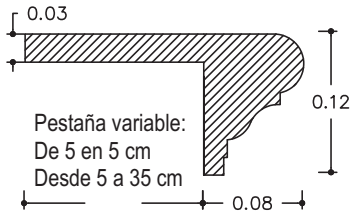

AMT-1

Antepecho Colonial A1
Vista Frontal: 0.12 m
Puntera y Pestaña variables

Peso x/ml : 23.8 kg

Largo máximo 2,40 m

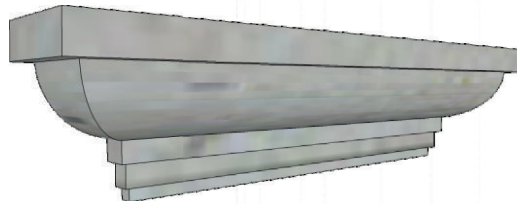
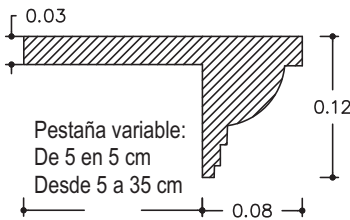

AMT-2

Antepecho Colonial A2
Vista Frontal: 0.12 m
Puntera y Pestaña variables

Peso x/ml : 25.8 kg

Largo máximo 2,40 m

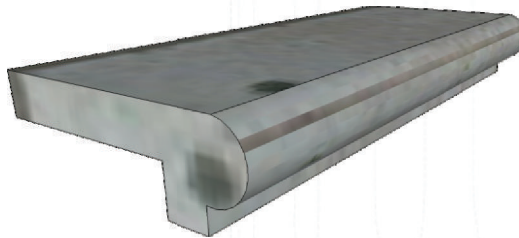
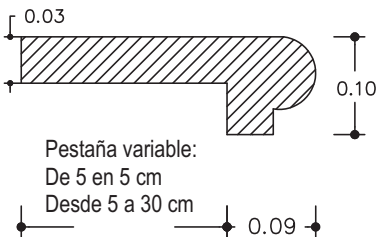

AMT-COR2

Antepecho Colonial COR2
Vista Frontal: 0.10 m
Pestaña variable
Sin Puntera/ corte recto
Peso x/ml : 36 kg

Largo máximo 2.40 m

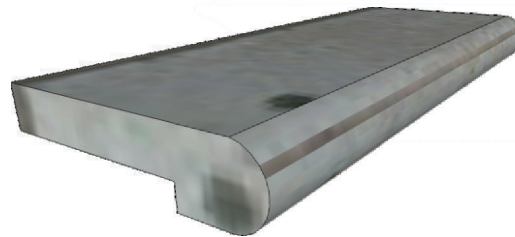
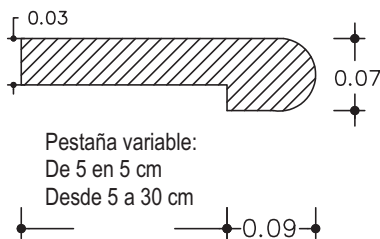

AMT-COR2V

Antepecho Colonial COR2
Vista Frontal: 0.07 m
Pestaña variable
Sin Puntera/ corte recto
Peso x/ml : 34 kg

Largo máximo 2.40 m

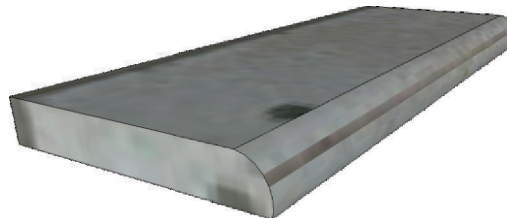
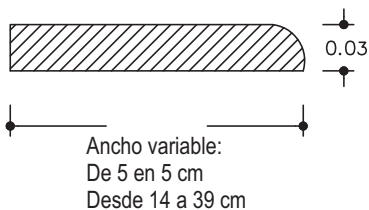

AMT-COR2M

Antepecho Colonial COR2
Vista Frontal: 0.05 m
Ancho variable
Sin Puntera/ corte recto
Peso x/ml : 30 kg

Largo máximo 1.20 m

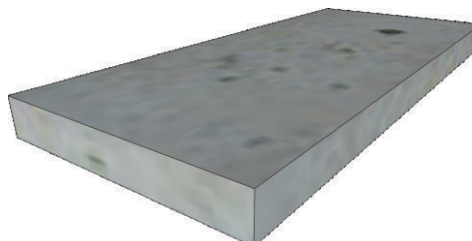
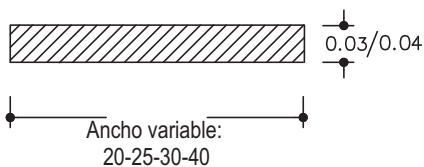

ANTEPECHO RECTO

AREC20	AREC25
Ancho: 0.20 m	Ancho: 0.25 m
Espesor: 0.04 m	Espesor: 0.04 m
Peso x/ml : 18.5 kg	Peso x/ml : 24 kg
AREC30-3	AREC40
Ancho: 0.30 m	Ancho: 0.40 m
Espesor: 0.03 m	Espesor: 0.04 m
Peso x/ml : 19.8 kg	Peso x/ml : 35.2 kg
AREC30-4	
Espesor: 0.04 m	
Peso x/ml : 26.4 kg	
Largo máximo 2.40 m	



Ruta 5 Km 24 - Alta Gracia



03547 - 430962 / 03547 - 15501860



E-mail: miguelangelpremoldeados@gmail.com

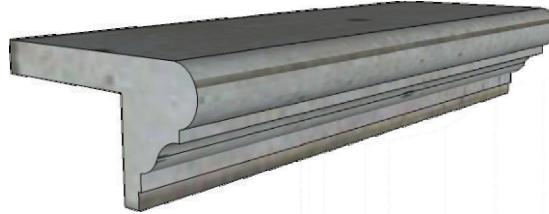
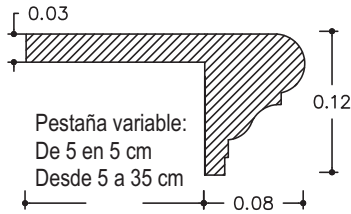

COR-1A

Cornisa con moldura MCOL-1
(AMT-1 sin punteras)
Vista Frontal: 0.12 m
Pestaña variable

Peso x/ml : 20 kg

Largo máximo 2,40 m

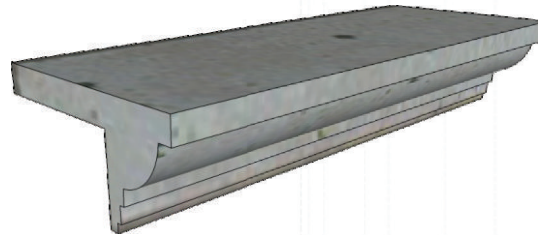
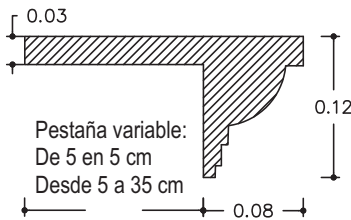

COR-1B

Cornisa con moldura MCOL-2
(AMT-2 sin punteras)
Vista Frontal: 0.12 m
Pestaña variable

Peso x/ml : 25.5 kg

Largo máximo 2,40 m

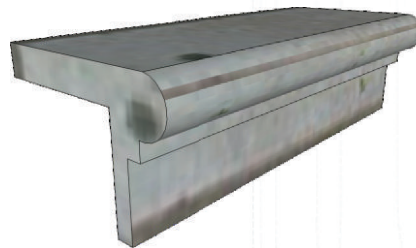
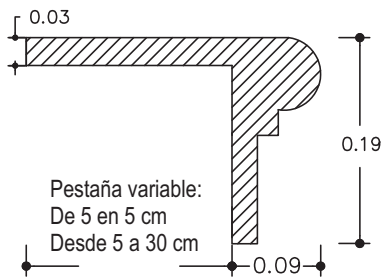

COR-2

Cornisa con moldura redonda
Vista Frontal: 0.19 m
Pestaña variable

Peso x/ml : 35.7 kg

Largo máximo 2.40 m

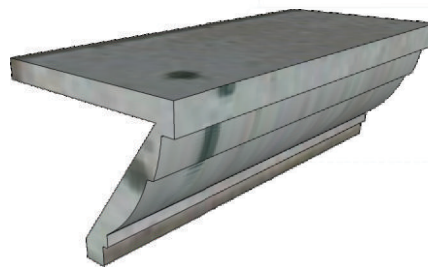
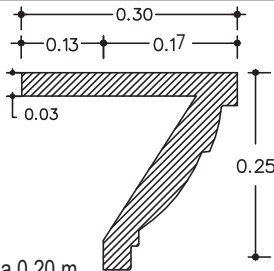

COR-4

Cornisa con moldura tipo MCOL2

Vista Frontal: 0.25 m
Pestaña: 0.20 m - Apoyo: 0.13 m

Peso x/ml : 56 kg

Largo máximo 2.40 m

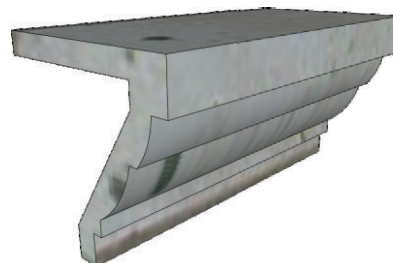
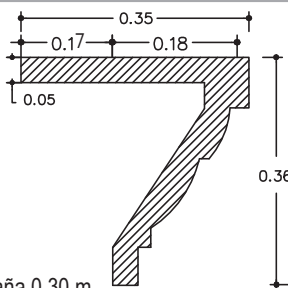

COR-5

Cornisa con moldura tipo MCOL2

Vista Frontal: 0.36 m
Pestaña: 0.30 m - Apoyo: 0.17 m

Peso x/ml : 69 kg

Largo máximo 2.40 m

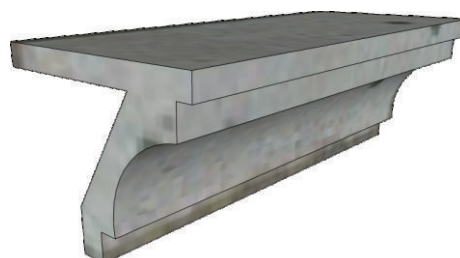
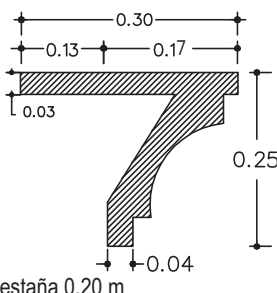

COR-7

Cornisa con moldura inversa

Vista Frontal: 0.25 m
Pestaña: 0.20 m - Apoyo: 0.13 m

Peso x/ml : 58 kg

Largo máximo 2.00 m